



TECNOSERVICE'21 srl

by Tinti Sergio
Via Carlo Pisacane, 134
61032 Fano (PU) Italy
P.IVA IT0200411413

Tel. +39 0721 805911
FAX +39 0721 809794
e-mail: staff@technochef.it
www.technochef.it
www.technochef.eu

Services and Technologies for professional catering since 1973



TECHNICAL CARD

Thermal input (Kw)	53,5
net weight (Kg)	140
breadth (mm)	1200
depth (mm)	900
height (mm)	900

PROFESSIONAL DESCRIPTION

GAS STOVE with 6 BURNERS on OPEN CABINET, MAXIMA 900 Line, HIGH POWER Series :

- **worktop** and front and **side panels** in **AISI 304 stainless steel** ;
- **interior** in **AISI 430** stainless steel;
- the **complete removability of the hob** , with completely rounded edges, guarantees **maximum hygiene and cleanliness** and above all easy maintenance;
- thanks to their full and rounded design, the **cast iron grids** create a single work surface where it is possible to move the pans easily;
- the **high thickness** guarantees long life and resistance, as well as easy cleaning;
- 80 mm **burners entirely in cast iron** , with regulation up to 3.5 kW, 108 mm, with regulation up to 7 kW and 130 mm, with regulation up to 12 kW;
- **open fire power n° x Kw : 1 x 3.5 Kw + 2 x 7 Kw + 3 x 12 Kw** ;
- **thermocouple safety valve** and **protected pilot flame** ;
- trays pressed in AISI 304 stainless steel.
- **the high energy efficiency** allows gas savings of at least 30% per year compared to traditional burners;
- **2 year warranty** .

Accessories/Options:

- 2 doors per compartment

CE mark

Made in Italy

CODE	DESCRIPTION	PRICE/DELIVERY
BS-G9F6M	GAS STOVE 6 BURNERS on OPEN CABINET, BERTOS MAXIMA 900 line, HIGH POWER Series, thermal power Kw.53,5, Weight 140 Kg, dim.mm.1200x900x900h	



HIGH POWER

12 kW	12 kW	12 kW
7 kW	3,5 kW	7 kW

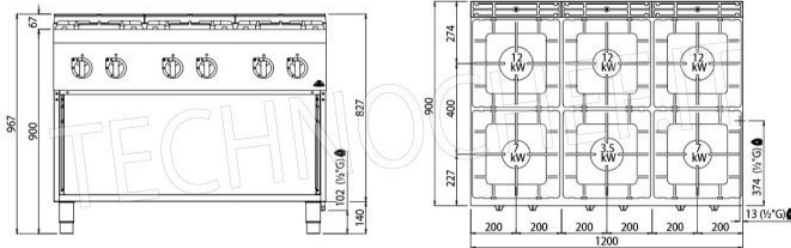



Cucine HIGH POWER



Sono caratterizzate da bruciatori interamente in ghisa ad alto spessore, elevata potenza e grande produttività. Ideali per l'utilizzo di pentole anche di grandi dimensioni. L'alta efficienza energetica permette un risparmio di gas di almeno il 30% all'anno rispetto ai bruciatori tradizionali.