



**TECNOSERVICE'21 srl**

by Tinti Sergio  
Via Carlo Pisacane, 134  
61032 Fano (PU) Italy  
P.IVA IT0200411413

Tel. +39 0721 805911  
FAX +39 0721 809794  
e-mail: [staff@technochef.it](mailto:staff@technochef.it)  
[www.technochef.it](http://www.technochef.it)  
[www.technochef.eu](http://www.technochef.eu)

Services and Technologies for professional catering since 1973



CODE	DESCRIPTION	PRICE/DELIVERY
<b>SI-IP20MAN</b>	Manual meat mixer in stainless steel, bowl capacity 20 Kg, removable stainless steel blade, 2 mixing speeds, Weight 13 Kg, dim.mm.400x340x403h	<b>Delivery</b> from 8 to 15 days

#### PROFESSIONAL DESCRIPTION

**STAINLESS STEEL MANUAL MEAT MIXER with 20 Kg BOWL, ideal for SMALL DOUGH, both in BUTCHER'S and RESTAURANTS :**

- **Construction** in Aisi 304 stainless steel ;
- **Shovel** in Aisi 304 stainless steel easily removable without tools;
- **Reducer** with hardened and ground gears ;
- **Gear protection system** with double oil seal;
- **2 mixing speeds** :
  - 1:1 in direct engagement with the blade
  - 1:3 for more tenacious doughs.
- **Practical and compact** .

#### TECHNICAL DATA :

- Bowl dimensions: mm 270x300
- Capacity: 28 liters / 20 kg
- Net weight: 13 kg
- Dimensions: 400x340x403mm

• **CE mark**  
**Made in Italy**

#### TECHNICAL CARD

<b>net weight (Kg)</b>	13
<b>breadth (mm)</b>	400
<b>depth (mm)</b>	340
<b>height (mm)</b>	403





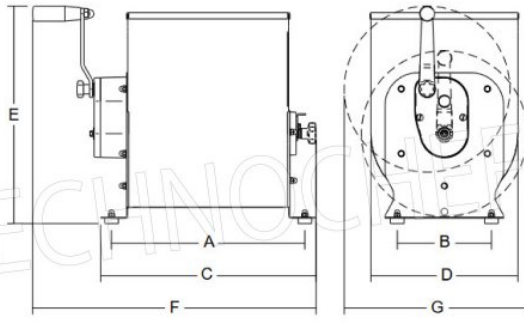

	①	②	A	B	C	D	E	F	G	⚖	📦
	mm	h/kg	mm	mm	mm	mm	mm	mm	mm	kg	kg
IP 20 Man	270x300	28/20	360	175	400	273	403	527	340	13	23